

# Air Assist User Manual

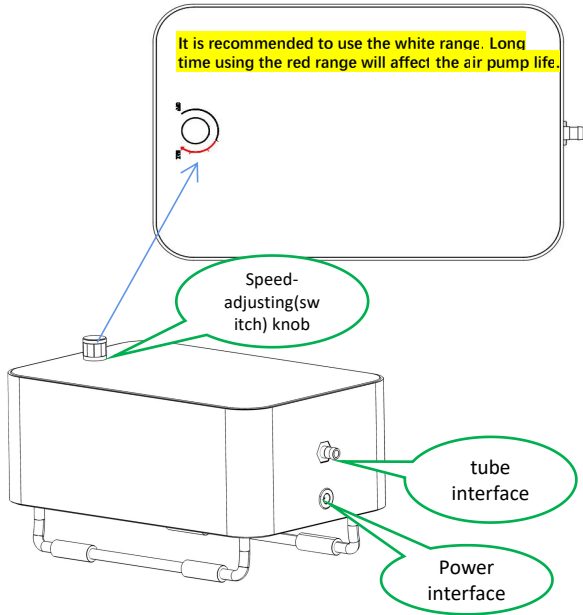

## Precautions for use

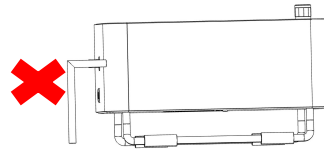

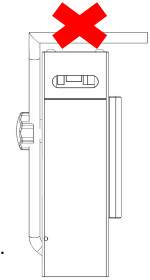
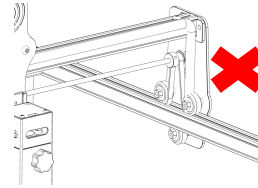



# Manuale utente Air Assist

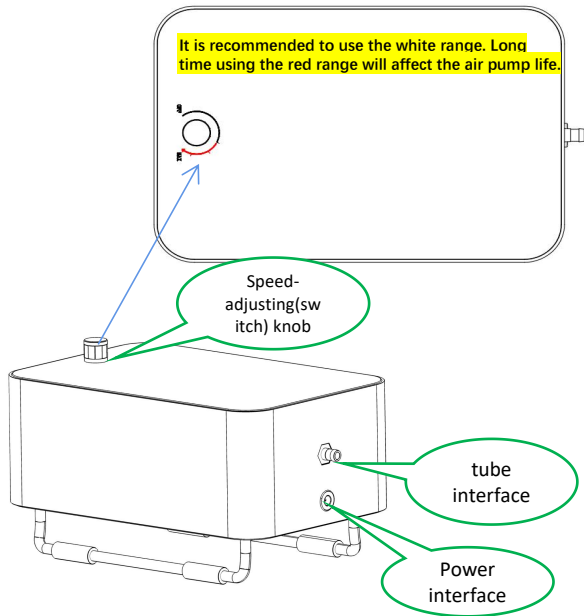

## Precauzioni per l'uso

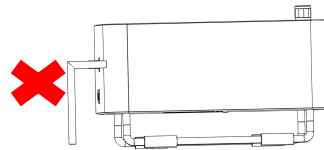
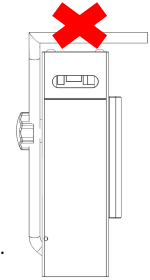
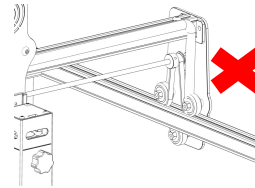

# Manual de usuario de asistencia aérea

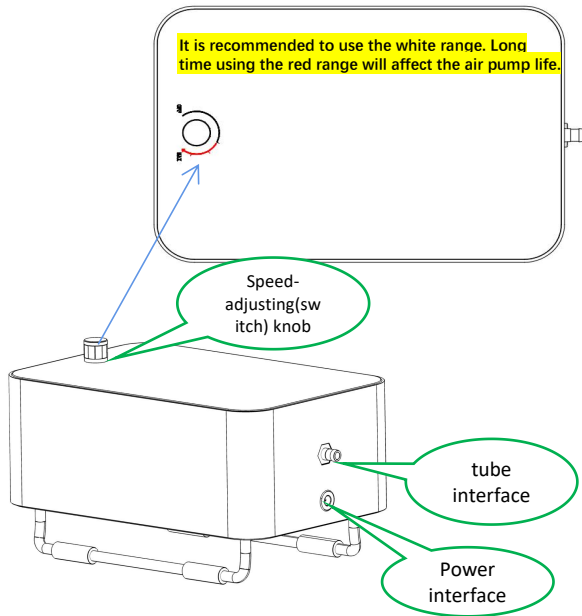

## Precauciones de uso

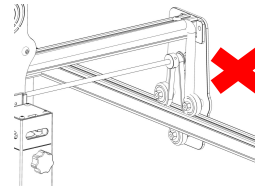

Be careful not to get the tube stuck by the wheels.

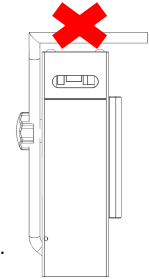

Please do not bend the tube too much to make the tube blocked.

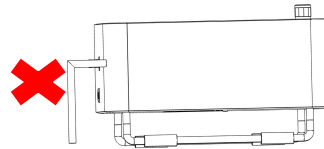

Please be aware of the tube cannot be bent too much to make the tube blocked, which would cause the pump burnt out.